

No.	Part number	Part name(ENGLISH)	QTY. on each bike	REMARK
-----	-------------	--------------------	-------------------	--------

发动机部分: ENGINE

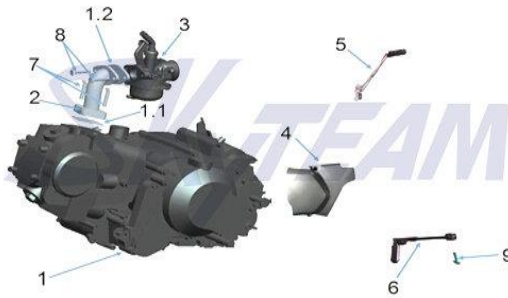

1	11000-22A00	50cc Engine	1	50cc
	11000-22H00	125cc Engine	1	125cc
1.1	11013-Z1000	Paper Gasket	1	50cc
	11013-18H00		1	125cc
1.2	11012-Z1000	Gasket	1	50cc
	11012-18H00		1	125cc
2	11010-22A00	Intake Manifold	1	50cc
	11010-22H00		1	125cc
3	16100-Z1010	Carburetor	1	50cc
	16100-18H00		1	125cc
4	11001-22H10	Left Side Cover, Engine	1	
5	26300-14A00	Kick Starter lever	1	
6	25600-18H00	Shift Pedal Assy	1	
7	81115-Y1000	Bolt	2	
8	GB/T 5783 M6X25-Zn.DJ	Bolt	2	50cc
	GB/T 5783 M6X30-Zn.DJ	Bolt	2	125cc
9	GB/T70.1 M6X20-Zn.DJ	Bolt	1	

车架: FRAME



1	41100-22H30	Frame Comp (Color)	1	
2	09112-14A10	Bolt	1	
3	09113-Z1000	Bolt	1	
4	GB/T 6187.1 M8-Zn.DJ	Flange Nut	2	

单撑: SIDE STAND

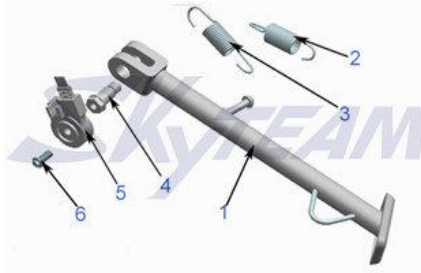

1	42310-22H00	Side Stand	1	
2	42312-Z1000	Outer Spring, Side Stand	1	
3	42321-Z1000	Inner Spring, Side Stand	1	
4	42311-23H00	Bolt, Side Stand	1	
5	42313-Y1000	Switch, Side Stand	1	
6	42315-Y1000	Bolt, Side Stand Switch	1	

搁脚部分: FOOTREST ASSY



1	43510-22H00	Front Footrest Assy	1	
2	GB/T 5783 M8X20-Zn.DJ	Bolt	4	
3	GB/T 97.1 8-Zn.DJ	Washer	4	
4	GB/T 93 8-Zn.DJ	Spring Washer	4	
5	GB/T 16674 M8X16-Zn.DJ	Flange Bolt	2	
6	43530-22H00	Stop Collar, Brake Pedal	1	
7	43730-21H00	Rear Footrest Pedal Assy	2	

电器部分: ELECTRICAL COMPONENTS



1	36610-22H00	Wire Harness	1	before 2014.08
	36610-22H01		1	after 2014.08
2	32800-22H00	Rectifier Assy	1	
3	GB/T 16674 M6X12-Zn.DJ	Flange Bolt	1	
4	33400-Z1000	Ignition Coil	1	
5	32900-16H00	CDI Unit	1	
6	31800-Y1000	Start Relay	1	
7	38620-Y1001	Flash Relay	1	
8	38500-Y1000	Horn Assy	1	
9	33610-15A00	Battery	1	12V3Ah

10	41522-14A00	Band, Battery	1	
11	33620-22H00	Holder, Battery	1	
12	GB/T 5789 M6X12-Zn.DJ	Flange Bolt	1	
13	37100-21H00	Main switch	1	
14	37152-21H00	Bolt, Steering Lock	2	

仪表 : SPEEDOMETER



1	34100-22A00	Speedometer Assy	1	50cc
	34100-21H00		1	125cc
2	GB/T 818 M6X12-Zn.DJ	Screw	2	
3	34210-21H00	Indicator Light Component	1	
3.1	34114-14G00	Bulb, Speedometer	4	12V1.7W,can not supply
4	34211-21H00	Indicator Light Holder	1	
5	34220-21H00	Indicator Light Mounting Plate Com	1	
6	34231-21H00	ion Pad, Indicator Light Mounting	2	
7	34233-21H00	Bushing, Cushion Pad	2	
8	59260-21H00	Clamp	1	
9	59250-21H00	Clamp	1	
10	34232-21H00	Bolt	2	
11	GB/T 6187.1 M6-Zn.DJ	Flange Nut	2	

灯具 : LAMPS

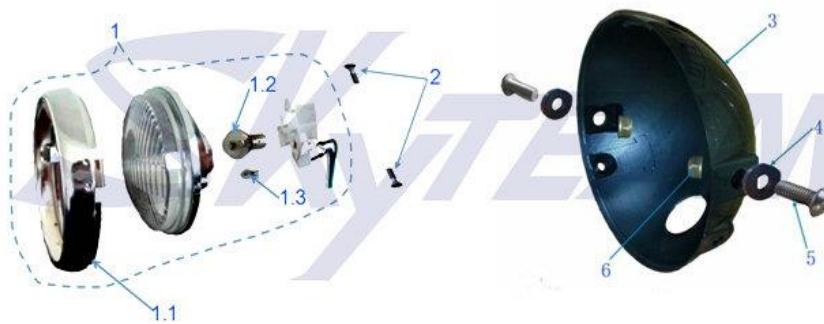

1	35100-21H00	Headlamp Assy	1	
1.1	35120-21H00	Ring, Headlamp Lens	1	can not supply
1.2	35107-Y1000	Bulb, Headlamp	1	Philips
1.3	35106-Y1000	Bulb, position	1	
2	GB/T 820 M5X16-Zn.DJ	Screw	2	
3	35131-21H00	Housing, Headlamp	1	
4	35122-14A00	Cushion	2	
5	GB/T 70.2-2000 M8X20-304	Flange Bolt	2	304 stainless steel
6	GB/T 6187.2 M8-Zn.DJ	Flange Nut	2	





1	51540-21H00	Headlamp Holder, Lh	1	
2	51530-21H00	Headlamp Holder, Rh	1	
3	51556-21H00	Cushion Pad	4	
4	35210-15H20	Signal Lamp Assy, Front, Lh	2	
5	35310-15H20	Signal Lamp Assy, Front, Rh	2	
5.1	35211-Y1000	Bulb, Signal Lamp	4	
6	GB/T 97.1 10-Zn.DJ	Washer	4	
7	GB/T 6170 M10X1.25-Zn.DJ	Nut	4	

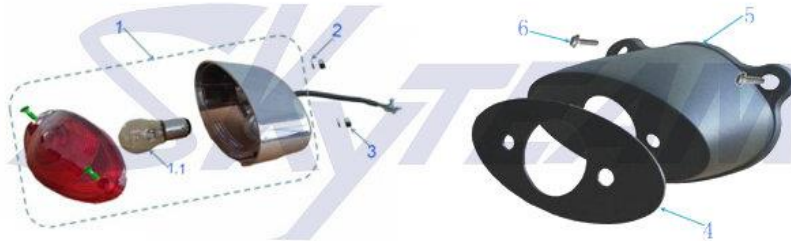

1	35710-22H00	Tail Lamp Assy (Ellipse)	1	
1.1	35711-Y1000	Bulb, Tail Lamp	1	
2	GB/T 97.1 6-Zn.DJ	Washer	2	
3	GB/T 6170 M6-Zn.DJ	Nut	2	
4	35914-21H00	Cushion, Rear Lamp	1	
5	35912-21H00	Support, Rear Lamp (color)	1	
6	GB/T 16674 M6x16-Zn.DJ	Flange Bolt	2	

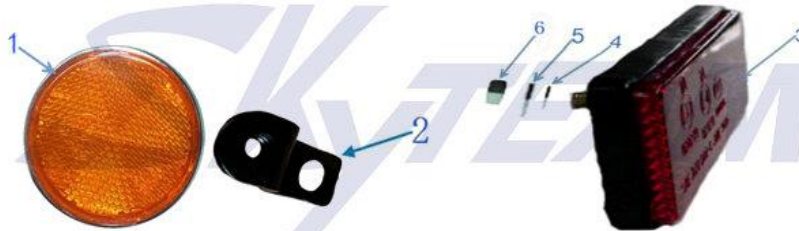

1	38110-Y1000	Side Reflector	2	
2	38111-22A00	Bracket, Side Reflector	2	
3	38160-Y1000	Rear Reflector	1	
4	GB/T 93 5-Zn.DJ	Spring Washer	1	
5	GB/T 96 5-Zn.DJ	Washer	1	
6	GB/T 6170 M5-Zn.DJ	Nut	1	

手把开关: HANDLE SWITCHES

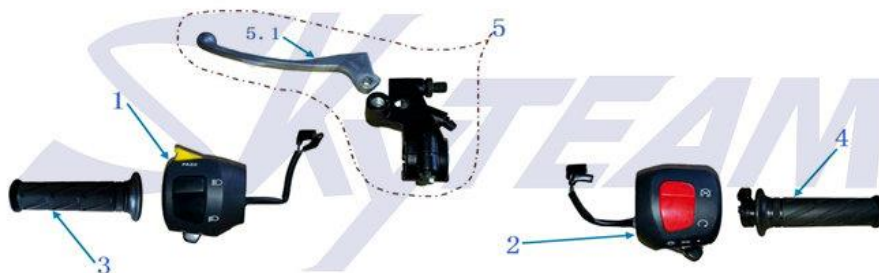

1	37300-22A01	Left Handle Switch	1	50cc
---	-------------	--------------------	---	------

1	37300-21H01	Left Handle Switch	1	125cc
2	37200-21H01	Right Handle Switch Assy	1	
3	57211-21H00	Grip, Lh	1	
4	57110-21H00	Grip, Throttle	1	
5	57500-21H00	Clutch Lever Assy	1	
5.1	57511-21H00	Lever, Clutch	1	

方向把：HANDLE BAR



1	56110-22H00	Handlebar	1	
2	56211-21H00	Handlebar Holder	2	
3	B/T 16674 M8X35-A2-70-30	Flange Bolt	4	
4	56121-21H00	Balance Weight	2	
5	56122-21H00	Rubber Spacer	4	
6	GB/T 819.1 M6X80-Zn.DJ	screw	2	
7	GB/T 6177.1 M6-Zn.DJ	nut	2	

前叉：FRONT FORK

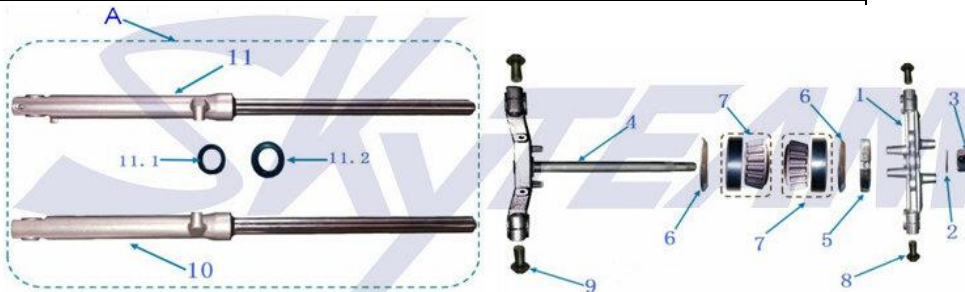

1	51311-21H00	Steering Head	1	
2	51612-Z1000-304	Washer	1	
3	51633-Z1000	Steering Nut	1	
4	51410-21H00	Steering Stem	1	
5	51615-Y1000	Steering Nut	1	
6	51614-Y1000	Dust Seal	2	
7	32005 GB/T 297-94	Needle Bearing, Upper	2	
8	GB/T 16674 M8X35-Zn.DJ	Flange Bolt	2	
9	B/T 5789 M10X1.25X50-Zn.	Flange Bolt	2	
A	51100-22H00	Front Shock Absorber	1	
10	51150-22H00	Shock Absorber, Front, Lh	1	
11	51160-22H00	Shock Absorber, Front, Rh	1	
11,1	51170-22H00	Oil Seal	2	
11,2	51180-21H00	Seal Cap	2	

后平叉 后减震：SWING ARM & REAR SHOCK ABSORBER





A	61000-22H00	Swing Arm Comp	1	
1	61100-22H00	Swing Arm Comp	1	
2	61277-22H00	Need Bearing	2	
3	61275-22H10	Bushing, Swing Arm	2	
4	61222-22H10	Dust Hood	2	
5	61211-22H10	Axle, Swing Arm	1	
6	GB 6187.2 M14X1.5-Zn.DJ	Flange Nut	1	
7	62100-22H00	Rear Shock Absorber Assy	2	
8	GB/T 96 10-Zn.DJ	Washer	4	
9	GB/T 97 12-Zn.DJ	Washer	2	
10	GB/T 923 M10X1.25-A2-70-3	Nut	4	

前轮: FRONT WHEEL

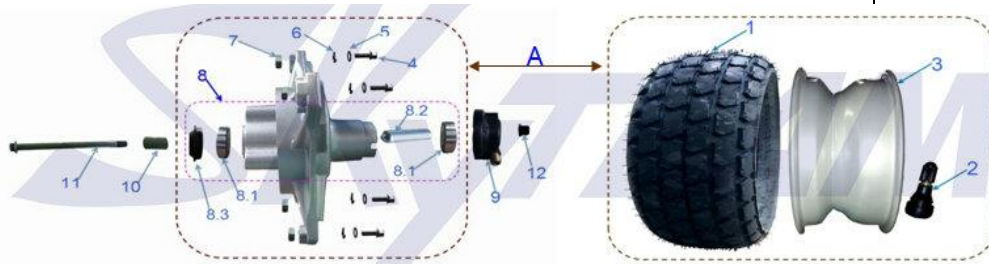

A	55000-22H30	Front Wheel Assy	1	
1	55700-22H20	Tire	1	
2	55501-22H00	Valve, tire	1	
3	55550-22H00	Rim, Front Wheel	1	
4	GB/T 5783 M8X25-Zn.DJ	Bolt	4	
5	GB/T 97.1 8-Zn.DJ	Washer	4	
6	GB/T 93 8-Zn.DJ	Spring Washer	4	
7	210221-Z1000	Nut	4	
8	54100-22H00	Hub, Front Wheel	1	
8.1	60301 GB/T 278-82	Bearing	2	
8.2	54123-22H00	Bushing	1	
8.3	09284-Z1000	Dust Seal	1	
9	54600-22H00	Gear Box Assy, Speedometer	1	
10	54121-Z1000	Bush, Front Wheel, L	1	
11	54711-22H00	Hub, Front Wheel(Used In Rear Wheel)	1	
12	GB/T 6187.2 M12-Zn.DJ	Flange Nut	1	

后轮: REAR WHEEL

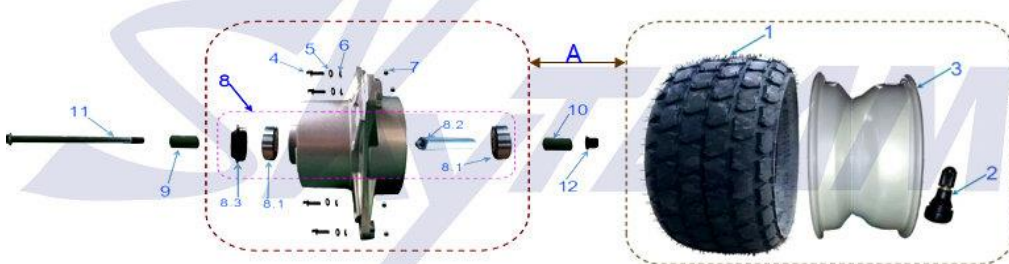

A	65000-22H30	Rear Wheel Assy	1	
1	55700-22H20	Tire	1	
2	55501-22H00	Valve, tire	1	
3	55550-22H00	Rim, Rear Wheel	1	
4	GB/T 5783 M8X25-Zn.DJ	Bolt	4	
5	GB/T 97.1 8-Zn.DJ	Washer	4	

6	GB/T 93 8-Zn.DJ	Spring Washer	4	
7	210221-Z1000	Nut	4	
8	64100-22H00	Hub, Front Wheel	1	
8.1	60301 GB/T 278-82	Bearing	2	
8.2	64123-22H00	Bushing	1	
8.3	210213-Z1000	Dust Seal	2	
9	65331-22H00	Bush, Rear Wheel, L	1	
10	65332-22H00	Spacer, Rear Wheel, R	1	
11	54711-22H00	Axle, Rear Wheel	1	
12	GB/T 6187.2 M12-Zn.DJ	Flange Nut	1	

传动部分: TRANSMISSION



1	420MH-108	Chain	1	50cc
	420MH-98		1	125cc
2	64511-22A00	Rear Sprocket	1	50cc
	64511-22H00		1	125cc
3	64512-18H00	Lock Plate, Sprocket	2	
4	5783 M10X1.25X25-10.9-2	Bolt	4	
5	61410-22H00	Adjuster, Chain	2	

前制动系统: FRONT BRAKE SYSTEM

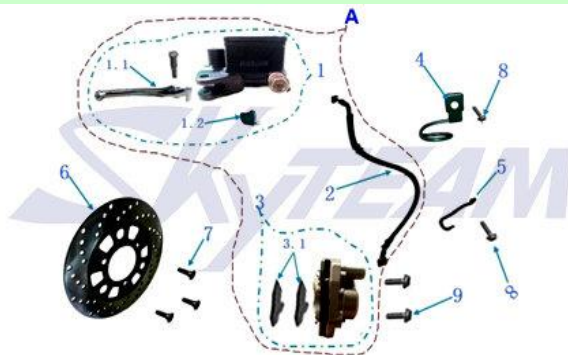

A	59000-22H00	Front Disc Brake Assy	1	
1	59600-21H00	Master Cylinder, Front Brake	1	cannot supply
1.1	59286-21H00	Front Brake Lever	1	
1.2	59285-21H00	Brake Switch, Front	1	
2	59480-21H00	Front Brake Hose	1	
3	59007-22H00	Caliper, Front Brake	1	
3.1	59312-Z1000	Front Brake Pad	1	
4	59242-21H00	Clamp, Brake Tube	1	
5	59242-Z1000	Clamp, Brake Hose	1	
6	59412-22H00	Front Brake Disc	1	
7	58412-Z1000	Bolt	3	
8	GB/T 16674 M6X12-Zn.DJ	Flange Bolt	2	
9	B/T 16674 M8X32-9.8-Zn.D	Flange Bolt	2	

后制动系统: REAR BRAKE SYSTEM



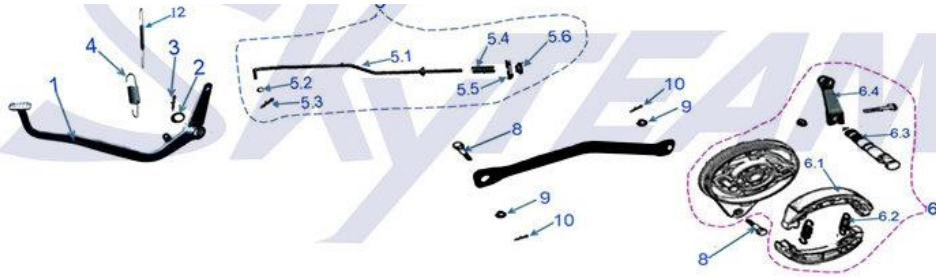

1	43110-22H00	Brake Rod Assy	1	
2	GB/T 97.1 16-Zn.DJ	Washer	1	
3	GB/T 91 3.2X25-Zn.DJ	Cotter Pin	1	
4	43121-22H00	Spring	1	
5	43300-22H00	Brake Rod Assy (Color)	1	
5.1	43311-22H00	Brake Rod (Color)	1	can not supply
5.2	GB/T 97.1 6-Zn.DJ	Nut	1	can not supply
5.3	GB/T 91 1.6X16-Zn.DJ	Cotter Pin	1	can not supply
5.4	210401-Z1000	Spring	1	can not supply
5.5	43313-Z1000	Pin	1	can not supply
5.6	43314-Z1000	Nut	1	can not supply
6	64200-22H00	Panel Comp, Rear Hub	1	
6.1	64202-Z1000	Rear Brake Shoe	2	
6.2	64203-Z1000	Spring	1	
6.3	64204-22H00	Cam, Rear Brake	1	
6.4	64205-Z1000	Lever, Rear Brake Cam	1	
7	65310-22H00	Torque Link, Rear	1	
8	70006-Z1000	Bolt	2	
9	GB/T 6170 M8-Zn.DJ	Cotter Pin	2	
10	GB/T 91 1.6X16-Zn.DJ	Nut	2	
11	37750-Z1000	Brake Switch, Rear	1	
12	43331-Z1000	Spring	1	

空滤： AIR FILTER

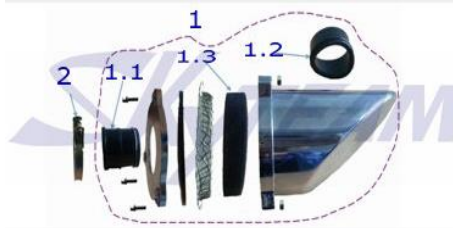

1	13700-22A00	Air Cleaner Assy	1	50cc
	13700-16H10		1	125cc
1,1	13723-16A00	Outlet Tube, Air Cleaner	1	50cc
	13723-16H10		1	125cc
1,2	13727-22A00	Inlet Tube, Air Cleaner	1	50cc
	13727-16H10		1	125cc
1,3	13725-16H10	Element, Air Cleaner	1	
2	13712-Y1000	Clip	1	

二次补气系统： SECOND AIR-IN SYSTEM





A	13800-17H20	Secondary Air System	1	
1	18400-21H00	Valve, Second Air System	1	
2	13810-18H00	Small Air Filter	1	
3	G1000-1016G	Inlet Hose, Second Air System	1	can not supply
4	G1000-1016G	Outlet Hose, Second Air System	1	can not supply
5	GJB00-1615C	Clip	4	can not supply
6				can not supply
7	13770-22H00	Steel Tube	1	
8	13740-Z1000	Graphite Gasket	1	
9	GB/T 16674 M6X16-Zn.DJ	Hexagon Flange Bolt	2	
10	GB/T 70.1 M6X35-Zn.DJ	Bolt	1	

消音器 : MUFFLER

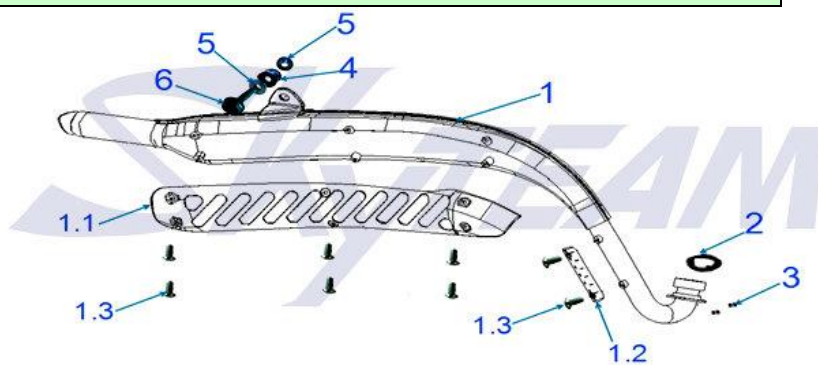

1	14300-22A00	EXhaust Pipe	1	50cc
	14300-22H00		1	125cc
1,1	14321-22H00	Cover, Muffler	1	
1,2	14322-22H00	Cover, Exhaust Pipe	1	
1,3	Q/DPT-6X12-A2-70-304	screw	2	
1,4	GB/T 97.1 6-A2-70-304	Washer	8	
1,5	GB/T 859 6-A2-70-304	Lock Washer	8	
2	14360-Z1000	Gasket, EXhaust Pipe	1	
3	GB/T 6177 M6-A2-70-304	Flange Nut	2	
4	14302-22H00	Cushion Washer	1	
5	14301-22H00	Bushing	2	
6	GB/T 16674 M10X30X1.25-Zn	Flange Nut	2	

前后泥板 : FRONT&REAR FENDER

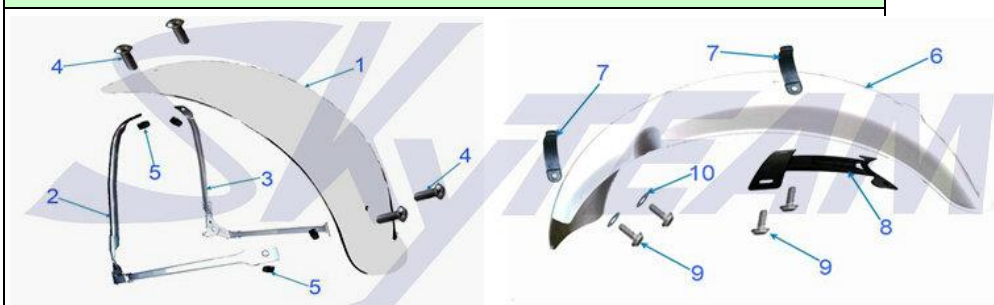

1	53110-22H00	Front Fender (Cr)	1	
2	51510-22H00	Holder,Front Fender, Lh	1	
3	51520-22H00	Holder,Front Fender, Rh	1	
4	Q/DPT-6X16-A2-70-304	Screw	4	
5	GB/T 6187.2 M6-Zn.DJ	Flange Nut	4	
6	63111-22H00	Rear Fender	1	
7	63121-22H00		2	
8	63112-22H00	Rear Fender Bracket	1	
9	GB/T 16674 M6X16-Zn.DJ	Flange Bolt	4	
10	GB/T 96 6-Zn.DJ	Washer	2	

油箱:FUEL TANK

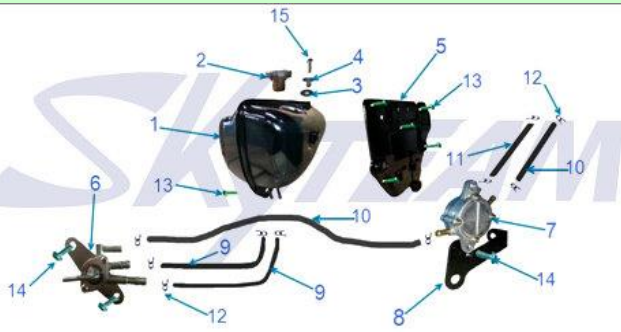

1	44100-22H10	Fuel Tank Comp	1	
2	44222-14A00	Fuel Tank Cap	1	
3	46123-Z1000	Rubber	1	
4	14315-Y1000	Bushing	1	
5	44104-22H00	Side Plate, Fuel Tank	1	
6	44300-Z1000	Fuel Cock	1	
7	44127-22H00	Fuel Pump	1	
8	44128-22H00	Fuel Pump Support	1	
9	G1000-4080P	Hose	2	
10	G1000-4080P	Hose	2	
11	G1000-4080P	Vacuum Pipe	1	
12	GJD00-8010C	Clip	10	
13	GB/T 16674 M6X12-Zn.DJ	Flange Bolt	6	
14	GB/T 16674 M6X20-Zn.DJ	Flange Bolt	3	
15	GB/T 16674 M6X25-Zn.DJ	Flange Bolt	1	

护板: PLASTIC COVERS

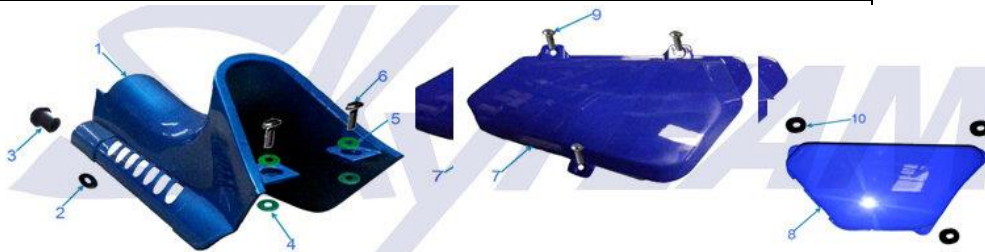

1	46110-22H00	Cover, Frame	1	
2	47316-10H00	Cushion Washer	1	
3	46421-15A00	Rubber	1	
4	34555-Y1000	Cushion Washer	2	
5	GB/T 96 6-Zn.DJ	Washer	2	
6	GB/T 16674 M6X12-Zn.DJ	Flange Bolt	2	
7	47111-22H00	shield, Lh	1	
8	47211-22H00	shield, Rh	1	
9	Q/DPT-6X16-A2-70-304	Screw	3	
10	09321-21H00	Cushion Washer	3	

链罩/工具发装板: CHAIN GUARD&TOOL HOLDER



1	61311-22H00	Chain Case	1	
2	GB/T 16674 M6X10-Zn.DJ	Flange Bolt	2	

3	46820-22H00	Holder, Tool Holder	1	
4	41522-14A00	Band, Tool Kits	1	
5	GB/T 16674 M6X12-Zn.DJ	Flange Bolt	2	

后货架/后牌支架: REAR CARRIER



1	46210-22H00-000	Rear Carrier	1	
2	GB/T 97.1 8-Zn.DJ	Washer	4	
3	GB70.1-2000 M8X16-Zn.D.	bolt	4	
4	63210-22H00	Bracket, License Plate	1	
5	45530-Y1000	License Support	1	
6	GB/T 16674 M6X12-Zn.DJ	Flange Bolt	4	

座垫: SEAT

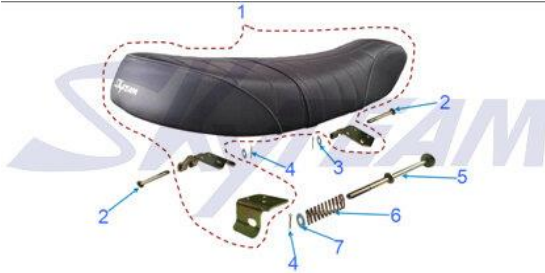

1	45100-22H00	Seat Assy (Color)	1	
2	GB/T 882-1986 B型	Pin	2	
3	GB/T 97.1 6-Zn.DJ	Washer	2	
4	GB/T 91 1.6X16-Zn.DJ	Cotter Pin	3	
5	45111-22H00	Pin	1	
6	45112-22H00	Spring	1	
7	GB/T 97.1 8-Zn.DJ	Washer	1	

后视镜: REAR MIRROR



1	56500/56600-Y1000	Rearview Mirror Assy	1	
---	-------------------	----------------------	---	--

操纵线: CABLES

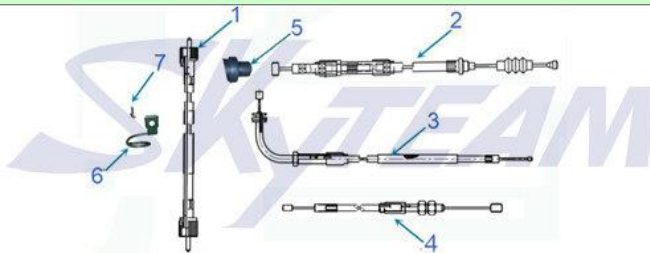

1	58200-22H00	Cable, Speedometer	1	
2	58400-22A00	Clutch Cable Assy	1	50cc
	58400-22H00		1	125cc
3	58300-22H00	Throttle Cable	1	

4	58500-22A00	Choke Cable Assy	1	50cc
5	57514-21H00		1	
6	58610-21H00	Upper Clamp, Speedometer Cable	1	
7	GB/T 5789 M6X12-Zn.DJ	Flange bolt	1	

贴花: **STICKERS**



1	89012-16A00	Fuel Tank Tape	2	
2	89081-22A00	Sticker, Shield, Lh	1	50cc
3	89081-22H00		1	125cc
4	89082-22A00	Sticker, Shield,Rh	1	50cc
5	89082-22H00		1	125cc

**REMARK: THE PARTS MARKED IN RED ARE THE ONES WE CANNOT
SUPPLY SEPARATELY.
THANKS FOR UNDERSTANDING!**

