

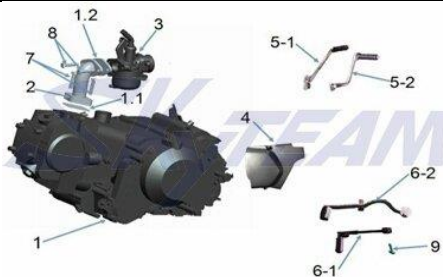

| No. | Part number | Part name(ENGLISH) | QTY. on each bike | REMARK |
|-----|-------------|--------------------|-------------------|--------|
|-----|-------------|--------------------|-------------------|--------|

发动机部分: ENGINE

| | | | | |
|-----|-----------------------|-------------------------|---|---------------|
| 1 | 11000-14A00 | 50cc Engine | 1 | ST50-6/6B |
| | 11000-17H00 | 125cc Engine | 1 | ST125-6/6B |
| | 11000-17H20 | | | ST125-6A |
| 1.1 | 11013-Z1000 | Paper Gasket | 1 | 50cc |
| | 11013-18H00 | | 1 | 125cc |
| 1.2 | 11012-Z1000 | Gasket | 1 | 50cc |
| | 11012-18H00 | | 1 | 125cc |
| 2 | 11011-14A10 | Intake Manifold | 1 | 50cc |
| | 11011-16H10 | | 1 | ST125-6/6B |
| | 11011-16H20 | | 1 | ST125-6A |
| 3 | 16100-Z1010 | Carburetor | 1 | 50cc |
| | 16100-18H00 | | 1 | 125cc |
| 4 | 11001-14A00 | Left Side Cover, Engine | 1 | Silver |
| | 11001-14A00-000 | | 1 | BLACK |
| | 11001-14A00-ODG | | 1 | Chrome |
| 5-1 | 26300-14A00 | Kick Starter | 1 | ST50/125-6/6B |
| 5-2 | 26300-13C00 | | 1 | ST125-6A |
| 6-1 | 25600-18H00 | Shift Pedal Assy | 1 | foldable |
| 6-2 | 25600-14A10 | | 1 | seesaw type |
| 7 | 81115-Y1000 | Bolt | 2 | |
| 8 | GB/T 5783 M6X25-Zn.DJ | Bolt | 2 | 50cc |
| | GB/T 5783 M6X30-Zn.DJ | Bolt | 2 | 125cc |
| 9 | GB/T70.1 M6X20-Zn.DJ | Bolt | 2 | |

车架: FRAME

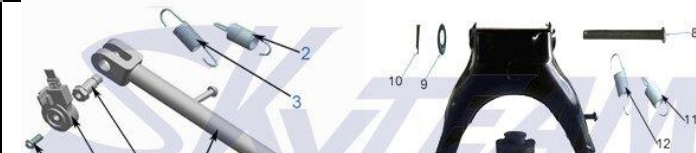

| | | | | |
|---|----------------------|------------------------|---|--|
| | 41100-14A10 | Frame | 1 | |
| 3 | 09112-14A00 | Bolt | 1 | |
| | 09112-14A10 | | 1 | |
| 4 | GB/T 6187.1 M8-Zn.DJ | Flange Nut | 2 | |
| 5 | 41211-14A00 | Decoration Strip | 1 | |
| 6 | 41212-14A00 | Clip, Decoration Strip | 3 | |

单撑、双撑 SIDE STAND&CENTER STAND

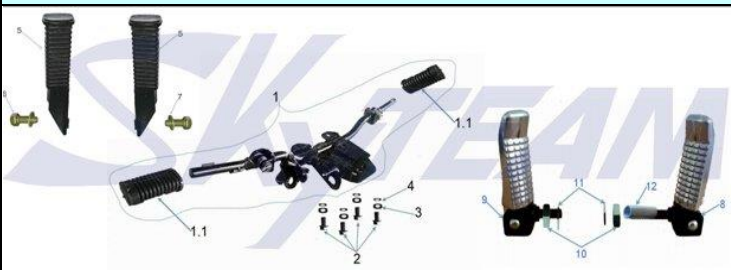

| | | | | |
|----|----------------------|--|---|---------------|
| 1 | 42310-14A10 | Side Stand | 1 | ST50/125-6/6A |
| | 42310-17H00 | | 1 | ST50/125-6B |
| 2 | 42312-Z1000 | Outer Spring, Side Stand | 1 | |
| 3 | 42321-Z1000 | Inner Spring, Side Stand | 1 | |
| 4 | 42311-23H00 | Bolt, Side Stand | 1 | |
| 5 | 42313-Y1000 | Switch, Side Stand | 1 | |
| 6 | 42315-Y1000 | Bolt, Side Stand Switch | 1 | |
| 7 | 42100-14A10 | Center Stand | 1 | |
| 8 | 42211-14A00 | Shaft, Center Stand | 1 | |
| 9 | GB/T 97.1 16-Zn.DJ | Washer | 1 | |
| 10 | GB/T 91 3.2X25-Zn.DJ | Cotter Pin | 1 | |
| 11 | 42312-Z1000 | Outer Spring, Side Stand (used for center stand) | 1 | |
| 12 | 42232-14A00 | Inner Spring | 1 | |
| 13 | 42222-14A00 | Cushion, Stand Center | 1 | |

前后搁脚部分: FRONT FOOTREST&REAR FOOTREST



| | | | | |
|-----|-----------------------------|--------------------------|---|------------------------|
| 1 | 43510-14A10 | Front Footrest Assy | 1 | |
| 1.1 | 43511-Z1000 | Rubber, Front Footrest | 2 | |
| 2 | GB/T 5783 M8X20-Zn.DJ | Bolt | 4 | |
| 3 | GB/T 97.1 8-Zn.DJ | Washer | 4 | |
| 4 | GB/T 93 8-Zn.DJ | Spring Washer | 4 | |
| 5 | 43620-14A00 | Rear Footrest, Left | 2 | ST50/125 -6/6A (Iron) |
| 6 | GB/T 5786 M10X1.25X20-Zn.DJ | Bolt | 2 | |
| 7 | GB/T 97.1 10-Zn.DJ | Spring Washer | 2 | |
| 8 | 43620-Y1000 | Rear Footrest, Left | 1 | ST50/125-6B (Aluminum) |
| 9 | 43720-17H00 | Rear Footrest, Right | 1 | |
| 10 | GB/T 6170 M8-Zn.DJ | Nut | 2 | |
| 11 | GB/T 97.1 8-Zn.DJ | Spring Washer | 2 | |
| 12 | 61275-14A10 | Rubber, Pillion Footrest | 1 | |

电器部分: ELECTRICAL COMPONENTS

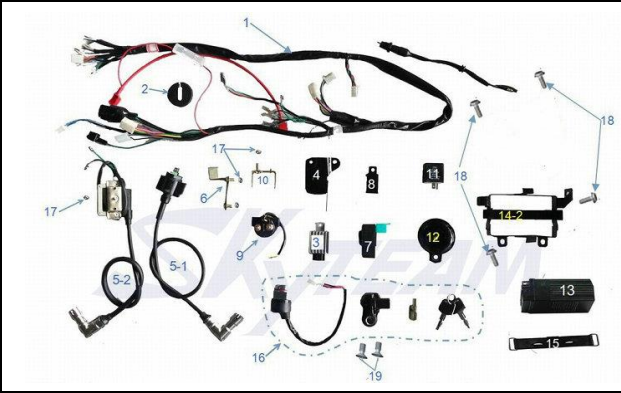

| | | | | |
|-----|-------------|---------------------------|---|--|
| 1 | 36610-17H01 | Wire Harness | 1 | |
| 2 | 36621-15A00 | Wire Harness cushion ring | 1 | |
| 3 | 32800-Z1000 | Rectifier Assy | 1 | |
| 4 | 32820-14A10 | Bracket, Rectifier | 1 | |
| 5-2 | 33400-17H00 | Ignition Coil | 1 | |
| 7 | 32900-16H00 | CDI Unit | 1 | |
| 8 | 32911-14A00 | bracket, CDI | 1 | |
| 9 | 31800-Y1000 | Start Relay | 1 | |
| 10 | 31810-14A00 | Bracket, Start Relay | 1 | |

| | | | | |
|------|------------------------|-----------------|---|---------------|
| 11 | 38620-Y1001 | Flash Relay | 1 | |
| 12 | 38500-14A00 | Horn Assy | 1 | |
| 13 | 33610-15A00 | Battery 12V3AH | 1 | ST50/125-6/6A |
| | 33610-17H00 | | 1 | ST50/125-6B |
| 14-1 | 41510-17H10 | Holder, Battery | 1 | |
| 15 | 41522-14A10 | Band, Battery | 1 | |
| 16 | 37000-14A00 | Lock Assy | 1 | |
| 17 | GB/T 6187.1 M6-Zn.DJ | Flange Nut | 2 | |
| 18 | GB/T 16674 M6X12-Zn.DJ | Flange Bolt | 5 | |
| 19 | GB 819.1 M6X12-Zn.DJ | Screw | 2 | |

仪表和灯具 :SPEEDOMETER & LAMPS

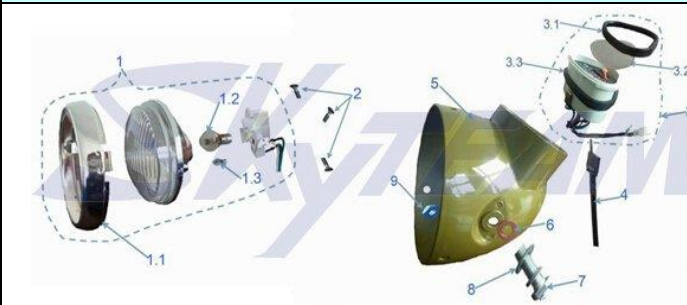

| | | | | |
|-----|----------------------------|----------------------------|---|----------------------------------|
| 1 | 35100-14A00 | Headlamp Assy | 1 | |
| 1.1 | 35112-14A00 | Ring, Headlamp Lens | 1 | Chrome, cannot supply separately |
| 1.2 | 35107-Y1000 | Bulb, Headlamp | 1 | Philips |
| 1.3 | 35106-Y1000 | Bulb, position | 1 | |
| 2 | GB/T 820 M5X16-Zn.DJ | Screw | 3 | |
| 3 | 34100-14A00 | Speedometer Assy (70km/h) | 1 | 50cc |
| | 34100-14G00 | Speedometer Assy (140km/h) | 1 | 125cc |
| 3.1 | 34112-14G00 | Plastic Ring, Speedometer | 1 | |
| 3.2 | 34113-14G00 | Faceplate, Speedometer | 1 | cannot supply separately |
| 3.3 | 34115-14G00 | Faceplate, | 1 | cannot supply separately |
| 4 | 58200-14A00 | Cable, Speedometer | 1 | |
| 5 | 35121-14A00 | Housing, Headlamp (color) | 1 | |
| 6 | 35122-14A00 | Cushion | 2 | |
| 7 | GB/T 16674 M8X25-A2-70-304 | Flange Bolt | 2 | 304 Stainless steel |
| 8 | GB/T 93 8-Zn.DJ | Washer | 2 | |
| 9 | GB/T 6170 M8-Zn.DJ-S14 | Nut | 2 | |

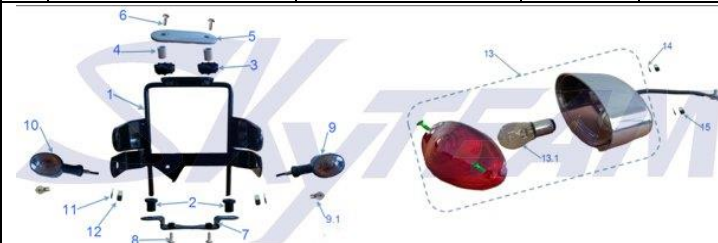

| | | | | |
|------|----------------------------|-----------------------------|---|---------------------|
| 1 | 46710-14A00 | Bracket, Head Lamp | 1 | |
| 2 | 46705-14A00 | Rubber | 2 | |
| 3 | 34120-10A00 | Rubber Ring | 1 | |
| 4 | 44415-15A00 | Bushing | 2 | |
| 5 | 51511-14A00 | Decorative Plate | 1 | |
| 6 | GB/T 16674 M6X25-A2-70-304 | Flange Bolt | 1 | 304 Stainless steel |
| 7 | 46720-10A00 | Mounting Plate, Lower | 1 | |
| 8 | GB/T 16674 M6X35-Zn.DJ | Bolt | 1 | |
| 9 | 35210-15H20 | Signal Lamp Assy, Front, Lh | 2 | ST50/125-6/6A |
| 10 | 35310-15H20 | Signal Lamp Assy, Front, Rh | 2 | |
| 9.1 | 35211-Y1000 | Bulb, Signal Lamp | 4 | |
| 11 | GB/T 97.1 10-Zn.DJ | Washer | 4 | |
| 12 | GB/T 6171 M10X1.25-Zn.DJ | Nut | 4 | |
| 13 | 35710-Y1000 | Tail Lamp Assy (Ellipse) | 1 | |
| 13.1 | 35711-Y1000 | Bulb, Tail Lamp | 1 | ST50/125-6/6A |

| | | | | |
|----|--------------------|--------|---|-------------|
| 14 | GB/T 97.1 6-Zn.DJ | Washer | 2 | ST50/125-6B |
| 15 | GB/T 6170 M6-Zn.DJ | Nut | 2 | |

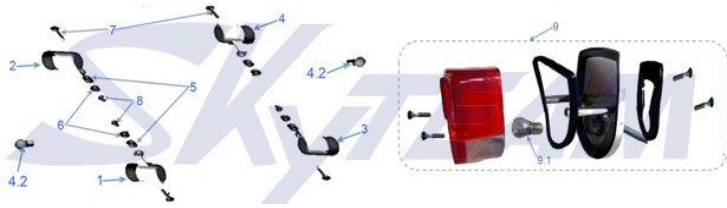

| | | | | |
|-----|------------------------|-----------------------------|---|-------------|
| 1 | 35210-17H00 | Signal Lamp Assy, Front, Lh | 1 | ST50/125-6B |
| 2 | 35310-17H00 | Signal Lamp Assy, Front, Rh | 1 | |
| 3 | 35510-17H00 | Signal Lamp Assy, Rear, Lh | 1 | |
| 4 | 35410-17H00 | Signal Lamp Assy, Rear, Rh | 1 | |
| 4.1 | 35211-Y1000 | Bulb, Signal Lamp | 4 | |
| 5 | 35608-17H00 | Rubber Ring | 4 | |
| 6 | 35609-17H00 | T-shape Bushing | 4 | |
| 7 | GB/T 16674 M6X25-Zn.DJ | Flange Bolt | 4 | |
| 8 | GB 6187.1 M6-Zn.DJ | Flange Nut | 4 | ST50/125-6B |
| 9 | 35710-17H00 | Tail Lamp Assy (Ellipse) | 1 | |
| 9.1 | 35711-Y1000 | Bulb, Tail Lamp | 1 | |



| | | | | |
|-----|--------------------|-------------------------|---|---------------|
| 1 | 38110-Y1000 | Side Reflector | 2 | ST50/125-6/6A |
| 2 | 38160-Y1000 | Rear Reflector | 1 | |
| 3 | GB/T 96 5-Zn.DJ | Washer | 1 | |
| 4 | GB/T 93 5-Zn.DJ | Spring Washer | 1 | |
| 5 | GB/T 6170 M5-Zn.DJ | Nut | 1 | |
| 6-1 | 38162-17H00 | Bracket, Rear Reflector | 1 | |
| 6-2 | 38162-14A00 | | 1 | |
| 7 | 47131-10H00 | Screw | 2 | ST50/125-6/6A |

手把开关: HANDLE SWITCHES



| | | | | |
|-----|-----------------|--------------------------|---|----------------------|
| 1 | 57600-15A10 | Left Handle Switch | 1 | ST50/125-6/6B MANUAL |
| 2 | 57600-15A10-0AD | | 1 | |
| 3 | 57600-15A10-010 | | 1 | |
| 4 | 57600-14A40 | | 1 | |
| 5 | 57600-14A40-010 | | 1 | |
| 1.1 | 57511-Z1000 | Lever, Clutch (alloy) | 1 | ST50/125-6/6B |
| 1.2 | 57511-Z1000-010 | Lever, Clutch (black) | 1 | |
| 1.3 | 57513-Z1000 | Bolt, Clutch Lever | 1 | |
| A | 57300-Z1010 | Right Handle Switch Assy | 1 | ST50/125-6A |
| B | 57300-Z1010-010 | | 1 | |
| 6 | 57310-Z1010 | Right Handle Switch | 1 | |
| 7 | 57310-Z1010-010 | | 1 | |
| 8 | 57320-Z1010 | Grip, Throttle | 1 | |
| 9 | 57210-Z1000 | Grip, Lh | 1 | |

方向把: HANDLE BAR

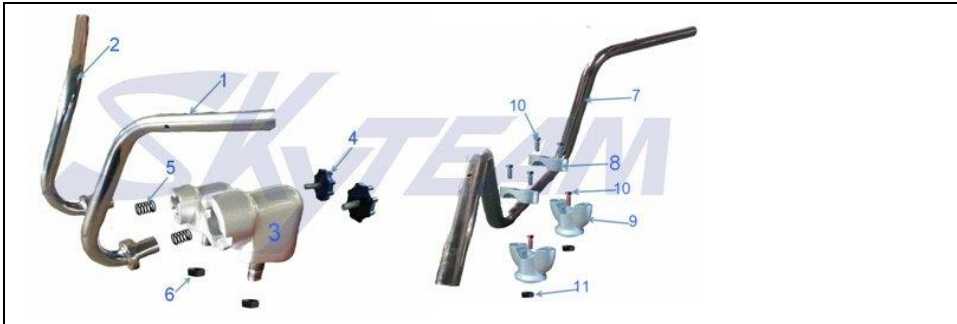

| | | | | |
|----|----------------------------|--------------------|---|-------------|
| 1 | 56110-15A00 | Handlebar, Lh | 1 | |
| 2 | 56120-15A00 | Handlebar, Rh | 1 | |
| 3 | 56140-15A00 | Holder, Handle Bar | 1 | |
| 4 | 56130-15A00 | Lock, Handlebar | 2 | |
| 5 | 56141-15A00 | Spring | 2 | |
| 6 | GB/T 6187.2 M10X1.25-Zn.DJ | Flange Nut | 2 | |
| 7 | 56110-16H20 | Handlebar, Lh | 1 | ST50/125-6B |
| 8 | 56221-Z1000 | Lock, Handlebar | 2 | |
| 9 | 56211-Z1000 | Holder, Handle Bar | 2 | |
| 10 | GB/T 16674 M8X35-A2-70-304 | Bolt | 4 | |
| 11 | 56223-Z1000 | Bolt | 2 | |
| 12 | GB/T 6187.2 M10X1.5-Zn.DJ | Flange Nut | 2 | |

前叉: FRONT FORK

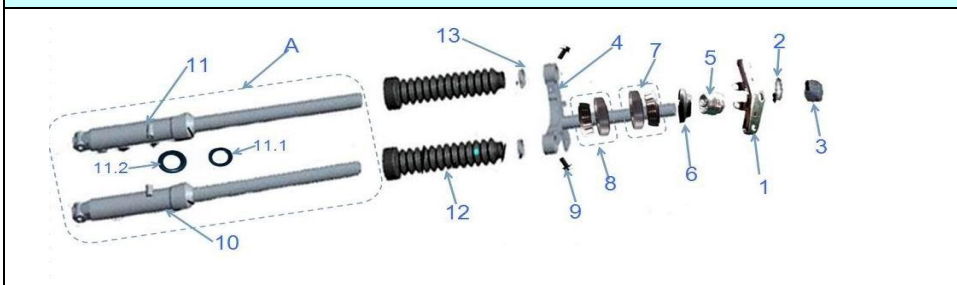

| | | | | |
|------|-----------------------|---------------------------|---|-----------------|
| 1 | 51310-14A00 | Steering Head | 1 | |
| 2 | 51612-Z1000-304 | Washer | 1 | stainless steel |
| 3 | 51633-Z1000 | Steering Nut | 1 | |
| 4 | 51410-14A10 | Steering Stem | 1 | |
| 5 | 51631-D0300 | Steering Nut | 1 | |
| 6 | 51643-D0300 | Dust Seal | 1 | |
| 7 | 51650-Z1000 | Needle Bearing, Upper | 1 | |
| 8 | 51660-Z1000 | Needle Bearing, Lower | 1 | |
| 9 | GB/T 5789 M8x35-Zn.DJ | Flange Bolt | 2 | |
| A | 51100-14A10 | Front Shock Absorber Assy | 1 | |
| 10 | 51150-14A10 | Shock Absorber, Front, Lh | 1 | |
| 11 | 51160-14A10 | Shock Absorber, Front, Rh | 1 | |
| 11,1 | 51170-16H00 | Oil Seal | 2 | |
| 11,2 | 51171-16H00 | Seal Cap | 2 | |
| 12 | 51159-17H00 | Sheath, Shock Absorber | 2 | |
| 13 | 51412-17H00 | Clamp | 2 | |

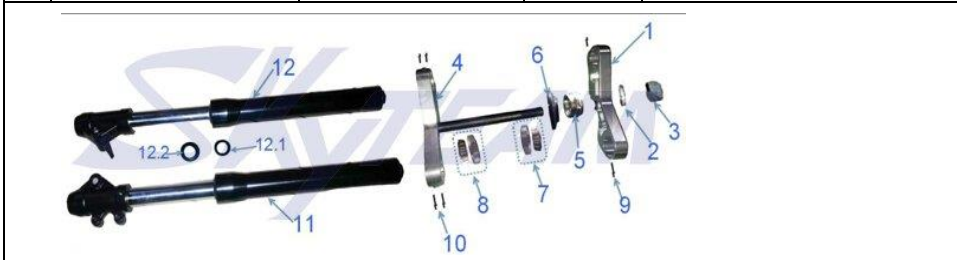

| | | | | |
|---|-----------------|---------------|---|--|
| 1 | 51310-17H10 | Steering Head | 1 | |
| 2 | 51612-Z1000-304 | Washer | 1 | |
| 3 | 51633-Z1000 | Steering Nut | 1 | |
| 4 | 51410-17H00 | Steering Stem | 1 | |
| 5 | 51631-D0300 | Steering Nut | 1 | |
| 6 | 51643-D0300 | Dust Seal | 1 | |

| | | | | |
|------|--------------------|---------------------------|---|------------------|
| 7 | 51650-Z1000 | Needle Bearing, Upper | 1 | ST50-6B/ST125-6B |
| 8 | 51660-Z1000 | Needle Bearing, Lower | 1 | |
| 9、10 | GB/T 70.1 M6X30-Cr | Bolt | 6 | |
| 11 | 52200-16H10 | Shock Absorber, Front, Lh | 1 | |
| 12 | 51160-17H00 | Shock Absorber, Front, Rh | 1 | |
| 12.1 | 51170-16H10 | Oil Seal | 2 | |
| 12.2 | 51171-16H10 | Seal Cap | 2 | |

后平叉 后减震: REAR SWING ARM & REAR SHOCK ABSORBER

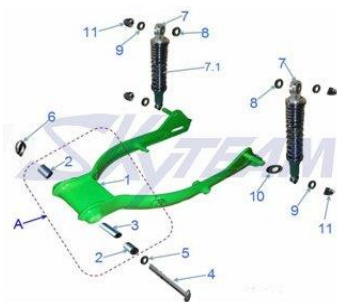

| | | | | |
|-----|-----------------------------|--------------------------|---|-----------------|
| A | 61000-14A00 | Swing Arm Comp | 1 | include Bushing |
| 1 | 61100-14A00 | Swing Arm Comp | 1 | |
| 2 | 61251-14A00 | Bushing | 2 | |
| 3 | 61276-14A00 | Middle Bushing | 1 | |
| 4 | 61211-14A00 | Axle, Swing Arm | 1 | |
| 5 | GB/T 97.1 10-Zn.DJ | Washer | 1 | |
| 6 | GB/T 6187.2 M10X1.25-Zn.DJ | Flange Nut | 1 | |
| 7 | 62100-14A10 | Rear Shock Absorber Assy | 2 | |
| 7.1 | 62170-14A10 | Oil Seal | 2 | |
| 8 | GB/T 97 12-Zn.DJ | Washer | 2 | |
| 9 | GB/T 96 10-Zn.DJ | Washer | 4 | |
| 10 | 61101-14A10 | Spacer | 1 | |
| 11 | GB/T 923 M10X1.25-A2-70-304 | Nut | 4 | stainless steel |

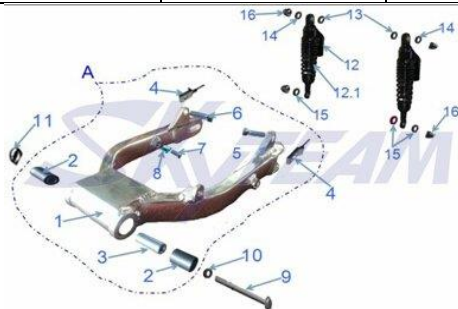

| | | | | |
|------|---------------------------------|--------------------------|---|--------------------------|
| A | 61000-17H00 | Aluminum Swing Arm Comp | 1 | ST50-6B/ST125-6B |
| 1 | 61100-17H00 | Aluminum Swing Arm | 1 | |
| 2 | 51120-16H10 | Bushing | 2 | |
| 3 | 61276-17H00 | Middle Bushing | 1 | |
| 4 | 61411-16H00 | Adjuster, Chain | 2 | |
| 5 | GB/T 5786 M10X1.25X45-Zn.DJ | Bolt | 1 | |
| 6 | 61101-16H10 | Bolt | 1 | |
| 7 | GB/T 5786 M10X1.25X25-9.8-Zn.DJ | Bolt | 1 | |
| 8 | | Bushing | 1 | cannot supply separately |
| 9 | 61211-14A10 | Axle, Swing Arm | 1 | ST50-6B/ST125-6B |
| 10 | GB/T 97.1 10-Zn.DJ | Washer | 1 | |
| 11 | GB/T 6187.2 M10X1.25-Zn.DJ | Flange Nut | 1 | |
| 12 | 62100-17H00 | Rear Shock Absorber Assy | 2 | |
| 12.1 | 62170-17H00 | Oil Seal | 2 | |
| 13 | GB/T 97 12-Zn.DJ | Washer | 2 | |
| 14 | GB/T 96 10-Zn.DJ | Washer | 2 | |
| 15 | 61101-14A10 | Spacer | 3 | |
| 16 | GB/T 923 M10X1.25-A2-70-304 | Nut | 4 | Stainless steel |

前轮: FRONT WHEEL



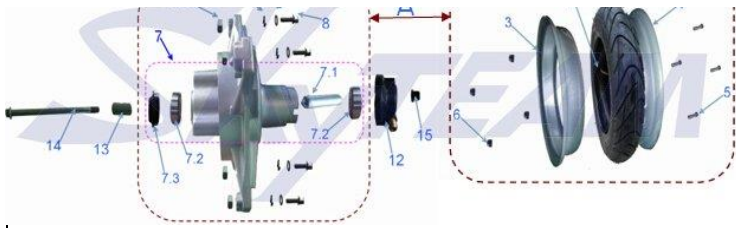

| | | | | |
|-----|----------------------------|---------------------------------------|----|---------------|
| A | 55000-14A10 | Front Wheel Assy | 1 | ST50/125/6/6A |
| | 55000-14A20 | | 1 | ST50/125*-6B |
| 1 | 55100-14A00 | Tire | 1 | ST50/125/6/6A |
| | 55100-14A20 | | 1 | ST50/125*-6B |
| 2 | 55200-14A00 | Tube, Inner | 1 | ST50/125/6/6A |
| | 55200-14A20 | | 1 | ST50/125*-6B |
| 3 | 54142-Z1000 | Rim, Lh(3.5-10) (Color) | 1 | ST50/125/6/6A |
| | 54141-17H00 | | 1 | ST50/125*-6B |
| 4 | 54141-Z1000 | Rim, Rh(3.5-10) (Color) | 1 | ST50/125/6/6A |
| | 54142-17H00 | | 1 | ST50/125*-6B |
| 5 | GB/T 16674 M6X12-Zn.DJ | Flange Bolt | 4 | ST50/125/6/6A |
| | GB/T 16674 M6X16-Zn. | Flange Bolt | 12 | ST50/125*-6B |
| 6 | GB/T 6187.1 M6-Zn.DJ | Flange Nut | 4 | ST50/125/6/6A |
| | | | 12 | ST50/125*-6B |
| 7 | 54100-Z1000 | Hub, Front Wheel | 1 | |
| 7.1 | 54123-Z1000 | Bushing | 1 | |
| 7.2 | GB/T 276 6301Z | Bearing | 2 | |
| 7.3 | 09284-Z1000 | Dust Seal | 1 | |
| 8 | GB/T 5783 M8X25-8.8-Zn.DJ | Bolt | 4 | |
| 9 | GB/T 97.1 8-Zn.DJ | Washer | 4 | |
| 10 | GB/T 859 8-Zn.DJ | Spring Washer | 4 | |
| 11 | 210221-Z1000 | Nut | 4 | |
| 12 | 54600-Z1000 | Gear Box Assy,Speedometer | 1 | ST50/125/6/6A |
| | 54600-17H00 | | 1 | ST50/125*-6B |
| 13 | 54121-Z1000 | Bush, Front Wheel, L | 1 | ST50/125/6/6A |
| | 55331-16H10 | | 1 | ST50/125*-6B |
| 14 | 54711-Z1000 | Axle, Front Wheel(Used In Rear Wheel) | 1 | ST50/125/6/6A |
| | 64711-Z1000 | | 1 | ST50/125*-6B |
| 15 | GB/T 6187.2 M12X1.25-Zn.DJ | Flange Nut | 1 | |

后轮: REAR WHEEL

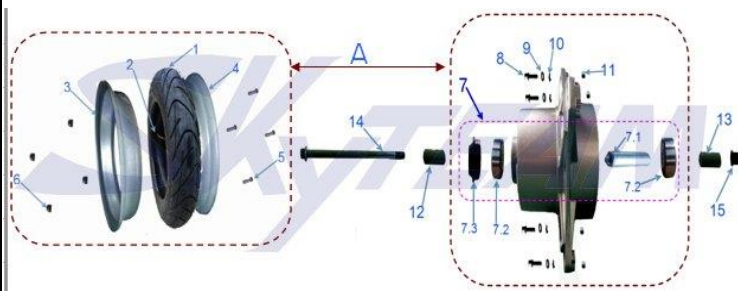

| | | | | |
|-----|------------------------|-------------------------|----|---------------|
| A | 65000-14A10 | Rear Wheel Assy(Color) | 1 | ST50/125/6/6A |
| | 65000-14A20 | | 1 | ST50/125*-6B |
| 1 | 55100-14A00 | Tire | 1 | ST50/125/6/6A |
| | 55100-14A20 | | 1 | ST50/125*-6B |
| 2 | 55200-14A00 | Tube, Inner | 1 | ST50/125/6/6A |
| | 55200-14A20 | | 1 | ST50/125*-6B |
| 3 | 54142-Z1000 | Rim, Lh(3.5-10) (Color) | 1 | ST50/125/6/6A |
| | 54142-17H00 | | 1 | ST50/125*-6B |
| 4 | 54141-Z1000 | Rim, Rh(3.5-10) (Color) | 1 | ST50/125/6/6A |
| | 54141-17H00 | | 1 | ST50/125*-6B |
| 5 | GB/T 16674 M6X12-Zn.DJ | Flange Bolt | 4 | ST50/125/6/6A |
| | GB/T 16674 M6X16-Zn.DJ | | 12 | ST50/125*-6B |
| 6 | GB/T 6187.1 M6-Zn.DJ | Flange Nut | 4 | ST50/125/6/6A |
| | | | 12 | ST50/125*-6B |
| 7 | 65300-Z1010 | Hub, Rear Wheel | 1 | |
| 7.1 | 210207-Z1000 | Middle Bushing | 1 | |
| 7.2 | GB/T 276 6301Z | Bearing | 2 | |
| 7.3 | 210213-Z1000 | Dust Seal, Left | 1 | |

| | | | | |
|----|----------------------------|---------------------|---|--|
| 8 | GB/T 5783 M8X25-8.8-Zn.DJ | Bolt | 4 | |
| 9 | GB/T 97.1 8-Zn.DJ | Washer | 4 | |
| 10 | GB/T 859 8-Zn.DJ | Spring Washer | 4 | |
| 11 | 210221-Z1000 | Nut | 4 | |
| 12 | 64121-14A00 | Bush, Rear Wheel, L | 1 | |
| 13 | 64122-14A00 | Bush, Rear Wheel, R | 1 | |
| 14 | 64711-14A00 | Axle, Rear Wheel | 1 | |
| 15 | GB/T 6187.2 M12X1.25-Zn.DJ | Flange Nut | 1 | |

传动部分: THE TRANSMISSION PARTS



| | | | | |
|---|---------------------------------|----------------------|---|---------------|
| 1 | 420MH-88 | Chain | 1 | ST50-6 |
| | 420MH-84 | | 1 | ST125-6/6A |
| | 420MH-90 | | 1 | ST50-6B |
| | 420MH-86 | | 1 | ST125-6B |
| 2 | 64511-10A00 | Rear Sprocket | 1 | ST50-6/6A/6B |
| | 64511-18H10 | | 1 | ST125-6/6A/6B |
| 3 | 64512-18H00 | Lock Plate, Sprocket | 2 | |
| 4 | GB/T 5786 M10X1.25X25-9.8-Zn.DJ | Bolt | 4 | |
| 5 | 61411-14A00 | Adjuster, Chain | 2 | |
| 6 | 61310-14A10 | Chain Case | 1 | ST50/125-6/6A |
| | 61310-14A20 | | 1 | ST50/125-6B |
| 7 | 53111-15A00 | Cushion | 1 | |
| 8 | GB/T 96 6-Zn.DJ | Washer | 1 | |
| 9 | GB/T 16674 M6X16-Zn.DJ | Bolt | 1 | |

前制动系统: FRONT BRAKE SYSTEM



| | | | | |
|-----|----------------------------|------------------------------|---|---------------|
| A | 59000-21G00 | Front Disc Brake Assy | 1 | ST50/125-6/6A |
| | 59000-16H10 | | 1 | ST50/125-6B |
| 1 | 59008-21G00 | Master Cylinder, Front Brake | 1 | ST50/125-6/6A |
| | 59008-16H10 | | 1 | ST50/125-6B |
| 1.1 | 59286-Z1000 | Front Brake Lever | 1 | old edition |
| | 59286-21G00 | Front Brake Lever | 1 | new edition |
| 1.2 | 59285-Z1000 | Brake Switch, Front | 1 | old edition |
| | 59285-21G00 | Brake Switch, Front | 1 | new edition |
| 2 | 59287-14A00 | Front Brake Hose | 1 | ST50/125-6/6A |
| | 59287-16H10 | | 1 | ST50/125-6B |
| 3 | 59007-Z1000 | Caliper, Front Brake | 1 | ST50/125-6/6A |
| | 59007-16H10 | | 1 | ST50/125-6B |
| 3.1 | 59312-Z1000 | Front Brake Pad | 1 | ST50/125-6/6A |
| | 59312-16H10 | | 1 | ST50/125-6B |
| 4 | 59489-Z1000 | Clamp, Brake Hose | 1 | |
| 5 | 59242-Z1000 | Clamp, Brake Hose | 1 | |
| 6 | 59414-Z1000 | Front Brake Disc | 1 | ST50/125-6/6A |
| | 59411-17H00 | | 1 | ST50/125-6B |
| 7 | 58412-Z1000 | Bolt | 3 | |
| 8 | GB/T 16674 M6X12-Zn.DJ | Flange Bolt | 1 | |
| 9 | GB/T 16674 M8X32-9.8-Zn.DJ | Flange Bolt | 2 | |

后制动系统: REAR BRAKE SYSTEM

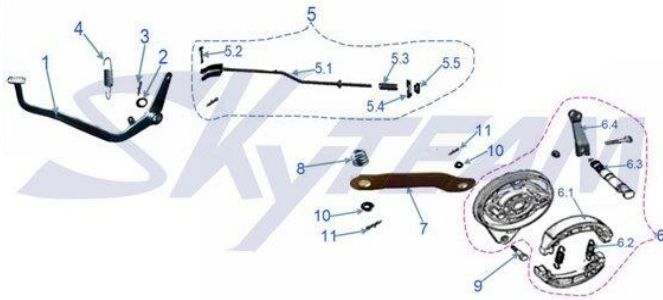

| | | | | |
|-----|----------------------|---------------------------|---|--------------------------|
| 1 | 43110-14A00 | Brake Rod Assy | 1 | |
| 2 | GB/T 97.1 16-Zn.DJ | Washer | 1 | |
| 3 | GB/T 91 3.2X25-Zn.DJ | Cotter Pin | 1 | |
| 4 | 43211-14A00 | Return Spring, Rear Brake | 1 | |
| 5 | 43300-14A00 | Brake Rod Assy (Color) | 1 | ST50/125-6/6A |
| | 43300-17H00 | | 1 | ST50/125-6B |
| 5,1 | 43311-14A00 | Brake Rod (Color) | 1 | cannot supply separately |
| 5,2 | 43312-Z1000 | Pin | 1 | cannot supply separately |
| 5,3 | 210401-Z1000 | Spring | 1 | cannot supply separately |
| 5,4 | 43313-Z1000 | Pin | 1 | cannot supply separately |
| 5,5 | 43314-Z1000 | Nut | 1 | cannot supply separately |
| 6 | 64200-14A00 | Panel Comp, Rear Hub | 1 | |
| 6,1 | 64202-Z1000 | Rear Brake Shoe | 2 | |
| 6,2 | 64203-Z1000 | Spring | 2 | cannot supply separately |
| 6,3 | 64204-Z1000 | Cam, Rear Brake | 1 | |
| 6,4 | 64205-14A00 | Lever, Rear Brake Cam | 1 | |
| 7 | 64311-21G00 | Linking Plate | 1 | cannot supply separately |
| 8 | 64312-14A00 | Spring | 1 | |
| 9 | 65311-14A00 | Bolt | 1 | |
| 10 | GB/T 6170 M8-Zn.DJ | Nut | 2 | |
| 11 | GB/T 91 2X20-Zn.DJ | Cotter Pin | 2 | |

空滤: AIR FILTER

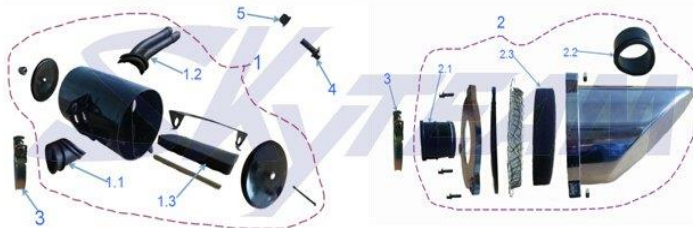

| | | | | |
|-----|------------------------|--------------------------|---|---------------|
| 1 | 13700-14A00 | Air Cleaner Assy | 1 | ST50-6/6B |
| 2 | 13700-16H10 | | | ST125-6/6A/6B |
| 1,1 | | Outlet Tube, Air Cleaner | 1 | ST50-6/6B |
| 2,1 | 13723-16H10 | | | ST125-6/6A/6B |
| 1,2 | | Inlet Tube, Air Cleaner | 1 | ST50-6/6B |
| 2,2 | 13727-16H10 | | | ST125-6/6A/6B |
| 1,3 | 13714-14A00 | Element, Air Cleaner | 1 | ST50-6/6B |
| 2,3 | 13725-16H10 | | | ST125-6/6A/6B |
| 3 | 13721-14A00 | Clip | 1 | 50/125 |
| 4 | GB/T 16674 M6X12-Zn.DJ | Flange Bolt | 1 | ST50-6/6B |
| 5 | GB/T 6187.1 M6-Zn.DJ | Flange Nut | 1 | |

二次补气系统: SECOND AIR-IN SYSTEM

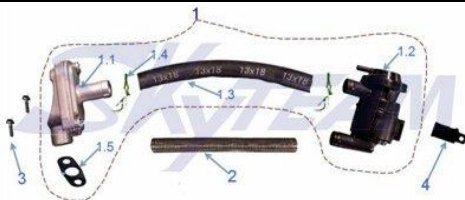

| | | | | |
|-----|-------------|--------------------------------|---|--|
| 1 | 13790-14A00 | Secondary Air System | 1 | |
| 1,1 | 13720-Z1000 | Control Valve | 1 | |
| 1,2 | 13710-Z1000 | Small Air Filter | 1 | |
| 1,3 | G1000-1318G | Outlet Hose, Second Air System | 1 | |

| | | | | |
|-----|------------------------|--------------------------|---|-----------|
| 1,4 | GJD00-1715C | Clip | 2 | ST50-6/6B |
| 1,5 | 13740-Z1000 | Graphite Gasket | 1 | |
| 2 | 13732-14A00 | Protective Spring | 1 | |
| 3 | GB/T 16674 M6X16-Zn.DJ | Flange Bolt | 2 | |
| 4 | 13791-14A00 | Holder, Small Air Filter | 1 | |

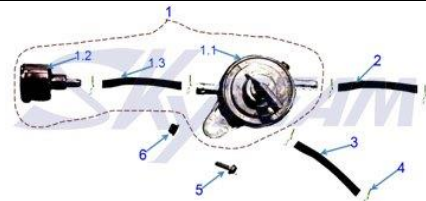

| | | | | |
|-----|-----------------------|----------------------|---|------------|
| 1 | 13800-17H00 | Secondary Air System | 1 | ST125-6/6B |
| 1,1 | 13820-18H00 | Control Valve | 1 | |
| 1,2 | 13810-18H00 | Filter | 1 | |
| 1,3 | G1000-4080P | Intake Manifold | 1 | |
| 2 | G1000-4080P | Blowdown Pipe | 1 | |
| 3 | G1000-4080P | Vacuum Pipe | 1 | |
| 4 | GJD00-8010C | Clip | 6 | |
| 5 | GB/T 5787 M6X16-Zn.DJ | Flange Bolt | 1 | |
| 6 | GB/T 6187.1 M6-Zn.DJ | Flange Nut | 1 | |

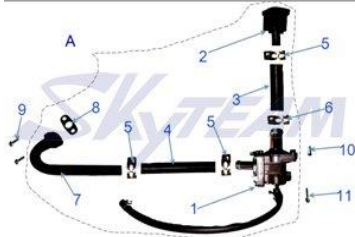

| | | | | |
|----|------------------------|--------------------------------|---|--------------------|
| A | 13800-17H20 | Secondary Air System | 1 | ST125-6A SEMI-AUTO |
| 1 | 18400-21H00 | Valve, Second Air System | 1 | |
| 2 | 13810-18H00 | Small Air Filter | 1 | |
| 3 | G1000-1016G | Inlet Hose, Second Air System | 1 | |
| 4 | G1000-1016G | Outlet Hose, Second Air System | 1 | |
| 5 | GJB00-1615C | Clip | 4 | |
| 6 | | | | |
| 7 | 13770-22H00 | Steel Tube | 1 | |
| 8 | 13740-Z1000 | Graphite Gasket | 1 | |
| 9 | GB/T 16674 M6X16-Zn.DJ | Hexagon Flange Bolt | 2 | |
| 10 | 13792-17H00 | Spacer | 1 | |
| 11 | GB/T 70.1 M6X50-Zn.DJ | Bolt | 1 | |

消音器: MUFFLER

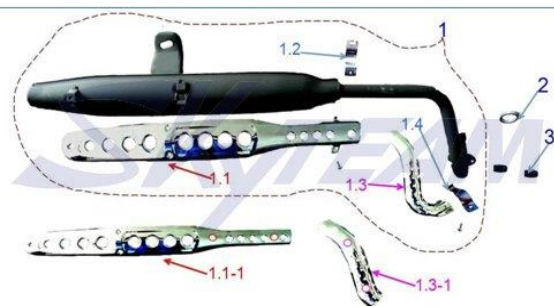

| | | | | |
|-------|------------------------|----------------------|---|--|
| 1 | 14300-14A00 | Muffler Comp(Color) | 1 | ST50-6 |
| | 14300-17H10 | | 1 | ST125-6/6A |
| 1,1 | 14321-14A00 | Cover, Muffler | 1 | before 2014-06 |
| 1,1-1 | 14321-14A10 | | 1 | after 2014-06, with new mounting system and less mounting brackets |
| 1,2 | 14322-14A00 | Clip | 1 | for old edition |
| 1,3 | 14311-14A00 | Cover, EXhaust Pipe | 1 | before2014-06 |
| 1,3-1 | 14311-14A10 | | 1 | after 2014-06 |
| 1,4 | 14312-14A00 | Clamp | 2 | for old edition, cannot supply separately |
| 2 | 14360-Z1000 | Gasket, EXhaust Pipe | 1 | |
| 3 | GB/T 6177 M6-A2-70-304 | Nut | 2 | |



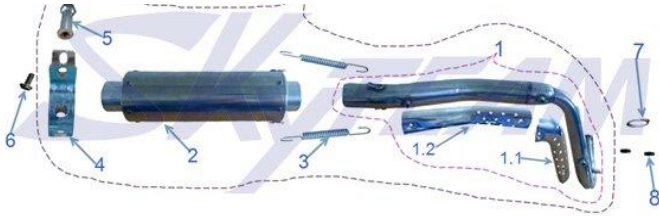

| | | | | |
|---------|------------------------|-----------------------|---|-------------|
| A | 14300-14A30 | Muffler Comp | 1 | ST50-6B |
| | 14300-17H40 | | 1 | ST125-6B |
| 1 | 14310-14A30 | EXhaust Pipe | 1 | ST50-6B |
| | 14310-17H40 | | 1 | ST125-6B |
| 1.1+1.2 | 14330-17H40 | Cover, EXhaust Pipe | 1 | ST50/125-6B |
| 1,1 | 14331-17H40 | Cover I, EXhaust Pipe | 1 | |
| 1,2 | 14332-17H40 | Cover I, EXhaust Pipe | 1 | |
| 2 | 14320-17H50 | Muffler Body | 1 | ST50-6B |
| | 14320-16H10 | | 1 | ST125-6B |
| 3 | 14302-16H10 | Spring | 2 | ST50/125-6B |
| 4 | 14301-16H10 | Clip | 1 | |
| 5 | 14321-16H00 | Spacer | 1 | |
| 6 | GB/T 16674 M8X20-Zn.DJ | Flange Bolt | 1 | |
| 7 | 14360-Z1000 | Gasket, EXhaust Pipe | 1 | |
| 8 | GB/T 6177 M6-A2-70-304 | Nut | 2 | |

前后泥板: FRONT&REAR FENDER

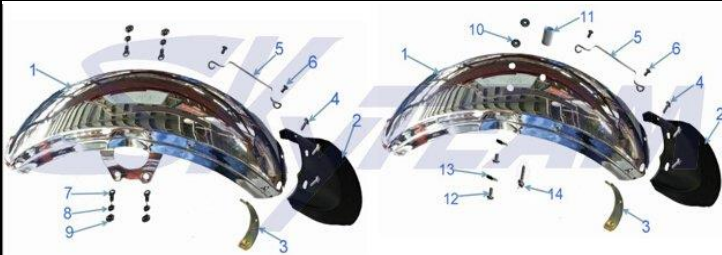

| | | | | |
|-----|------------------------|-------------------------|---|---------------|
| 1 | 53110-14A00 | Front Fender (Cr) | 1 | ST50/125-6/6A |
| 1-1 | 53110-17H00 | | 1 | ST50/125-6B |
| 2 | 53121-14A00 | Rear Part, Front Fender | 1 | |
| 3 | 53122-14A00 | Underboarding | 1 | |
| 4 | GB/T 16674 M6X10-Zn.DJ | Flange Bolt | 3 | |
| 5 | 53131-14A00 | Cable Clamp | 1 | ST50/125-6/6A |
| 6 | GB/T 820 M5X10-Zn.DJ | Flange Bolt | 2 | |
| 7 | GB 5783 M6X12-Zn.DJ | Bolt | 4 | |
| 8 | GB 97.1 6-140HV-Zn.DJ | Washer | 4 | |
| 9 | GB/T 859 6-Zn.DJ | Spring Washer | 4 | |
| 10 | 53111-15A00 | Rubber Ring | 2 | |
| 11 | 46125-Y1000 | Spacer | 1 | |
| 12 | GB/T 16674 M6X16-Zn.DJ | Flange Bolt | 2 | |
| 13 | GB/T 96 6-Zn.DJ | Washer | 2 | |
| 14 | GB/T 16674 M6X25-Zn.DJ | Flange Bolt | 1 | |

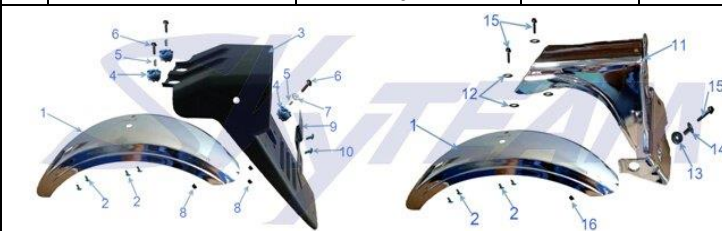

| | | | | |
|---|------------------------|------------------------|---|---------------|
| 1 | 63110-14A00 | Rear Fender | 1 | ST50/125-6/6A |
| 2 | GB/T 16674 M6X12-Zn.DJ | Flange Bolt | 4 | |
| 3 | 63112-14A00 | Rear Part, Rear Fender | 1 | |
| 4 | 34120-10A00 | Rubber Ring | 3 | |
| 5 | 44415-15A00 | Bushing | 3 | |
| 6 | GB/T 16674 M6X25-Zn.DJ | Bolt | 3 | |
| 7 | GB/T 96 6-Zn.DJ | Washer | 1 | |
| 8 | GB/T 6187.1 M6-Zn.DJ | Flange Nut | 3 | |
| 9 | 45530-Y1000 | Bracket, Licence Plate | 1 | |

| | | | | |
|----|------------------------|------------------------|---|-------------|
| 10 | GB/T 16674 M6X16-Zn.DJ | Flange Bolt | 2 | ST50/125-6B |
| 11 | 63112-14A10 | Rear Part, Rear Fender | 1 | |
| 12 | 35122-14A00 | Rubber Ring | 4 | |
| 13 | 46123-Z1000 | Rubber Ring | 1 | |
| 14 | 46124-Z1000 | Spacer | 1 | |
| 15 | GB/T 16674 M6X25-Zn.DJ | Bolt | 3 | |
| 16 | GB/T 6187.1 M6-Zn.DJ | Flange Nut | 1 | |

油箱:FUEL TANK

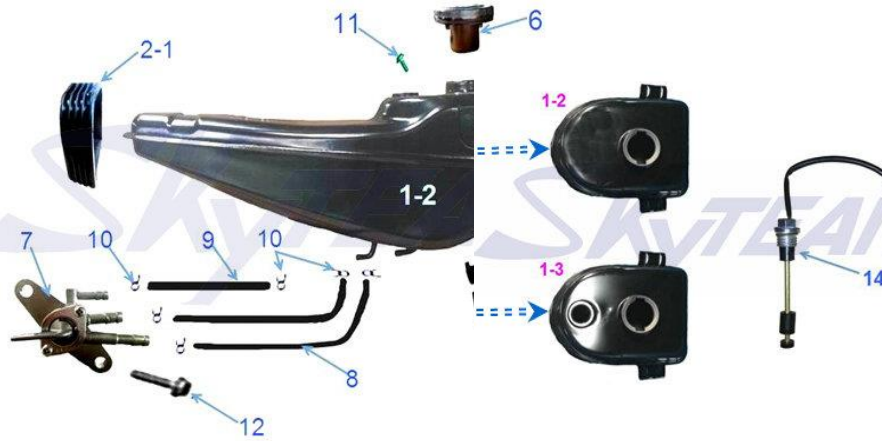

| | | | | |
|-----|------------------------|----------------------|---|---------------------|
| 1-2 | 44110-14A20 | 5.5L Fuel Tank Comp | 1 | |
| 1-3 | 44110-17H00 | 5.5L Fuel Tank Comp | 1 | with fuel tank hole |
| 2-1 | 44131-14A10 | Rubber Ring, Front | 1 | |
| 3-1 | 44132-14A10 | Rubber Ring, Lower | 2 | |
| 4 | 44120-14A00 | Set, Fuel Tank Cover | 1 | |
| 5 | 36622-14A00 | Rubber | 1 | |
| 6 | 44222-14A00 | Fuel Tank Cap | 1 | |
| 7 | 44300-Z1000 | Fuel Cock | 1 | |
| 8 | G1000-4080P-470 | Hose 1 | 2 | |
| 9 | G1000-4080P-20 | Hose 2 | 1 | |
| 10 | GJD00-8010C | Clip | 6 | |
| 11 | GB/T 16674 M6X12-Zn.DJ | Bolt | 2 | |
| 12 | GB/T 16674 M6X35-Zn.DJ | Hexagon Flange Bolt | 1 | ST50-6/6B |
| | GB/T 16674 M6X20-Zn.DJ | Hexagon Flange Bolt | 1 | ST125-6/6A/6B |
| 13 | GB/T 6177 M6-Zn.DJ | hexagon flange nuts | 1 | |
| 14 | 34810-21G00 | Fuel Level Gauge | 1 | fits 5.5L fuel tank |

座垫:SEAT



| | | | | |
|---|------------------------|-------------------|---|--|
| 1 | 45100-17H00 | Seat Assy (Color) | 1 | |
| 2 | 37611-14A00 | Rubber Ring | 1 | |
| 3 | 47411-14A00 | Tool Holder | 1 | |
| 4 | 13702-14A00 | Band, Tool Kits | 1 | |
| 5 | GB/T 16674 M6X20-Zn.DJ | Bolt | 1 | |
| 6 | GB/T 16674 M8X16-Zn.DJ | Flange Bolt | 2 | |

后货架:REAR CARRIER



| | | | | |
|-----|------------------------|--------------|---|--------|
| | | | | |
| 1 | 46110-14A10 | Rear Carrier | 1 | chrome |
| | 46110-14A10-000 | | 1 | black |
| 1-1 | 46110-14A20 | Rear Carrier | 1 | chrome |
| | 46110-14A20-000 | | 1 | black |
| 2 | GB/T 16674 M8X95-Zn.DJ | Flange Bolt | 2 | |

操纵线: HANDLE SWITCH

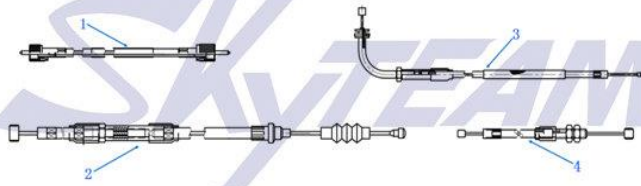

| | | | | |
|---|-------------|--------------------|---|---|
| 1 | 58200-14A00 | Cable, Speedometer | 1 | |
| 2 | 58400-14A00 | Clutch Cable Assy | 1 | ST50-6(B)/ ST125-6(B) engine with rotary gear |
| | 58400-17H00 | | 1 | ST125-6 |
| | 58400-17H10 | | 1 | ST125-6B |
| 3 | 58300-17H00 | Throttle Cable | 1 | ST50/125-6 |
| | 58300-17H10 | | 1 | ST50/125-6B |
| 4 | 58500-14A00 | Choke Cable Assy | 1 | ST50-6 |
| | 58500-14A10 | | 1 | ST50-6B |

后视镜: HANDLE SWITCH

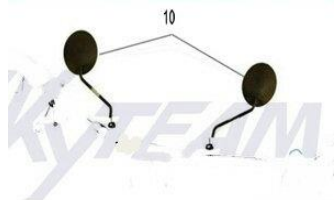

| | | | | |
|---|-------------------|----------------------|---|------|
| 1 | 56500/56600-14A00 | Rearview Mirror Assy | 1 | pair |
|---|-------------------|----------------------|---|------|

贴花: STICKERS



| | | | | |
|---|-------------|----------------|---|---------------|
| 1 | 89012-14A00 | Fuel Tank Tape | 2 | for 2.4L,4.4L |
| 2 | 89012-14A20 | Emblem | 2 | for 5.5L |
| 3 | 89012-17H00 | | 2 | ST50/125-6B |
| 4 | 89081-14A10 | | 2 | for 5.5L |
| 5 | 89011-14A00 | Model Decals | 1 | 50cc |
| 6 | 89011-17H00 | | 1 | 125cc |
| 7 | 89085-14A00 | Fuel Tank Tape | 2 | for 5.5L |

REMARK: THE PARTS MARKED IN RED ARE THE ONES WE CANNOT SUPPLY SEPARATELY.

THANKS FOR UNDERSTANDING!